

Iconic Island Dwellings Model # BC1466-222-C-1

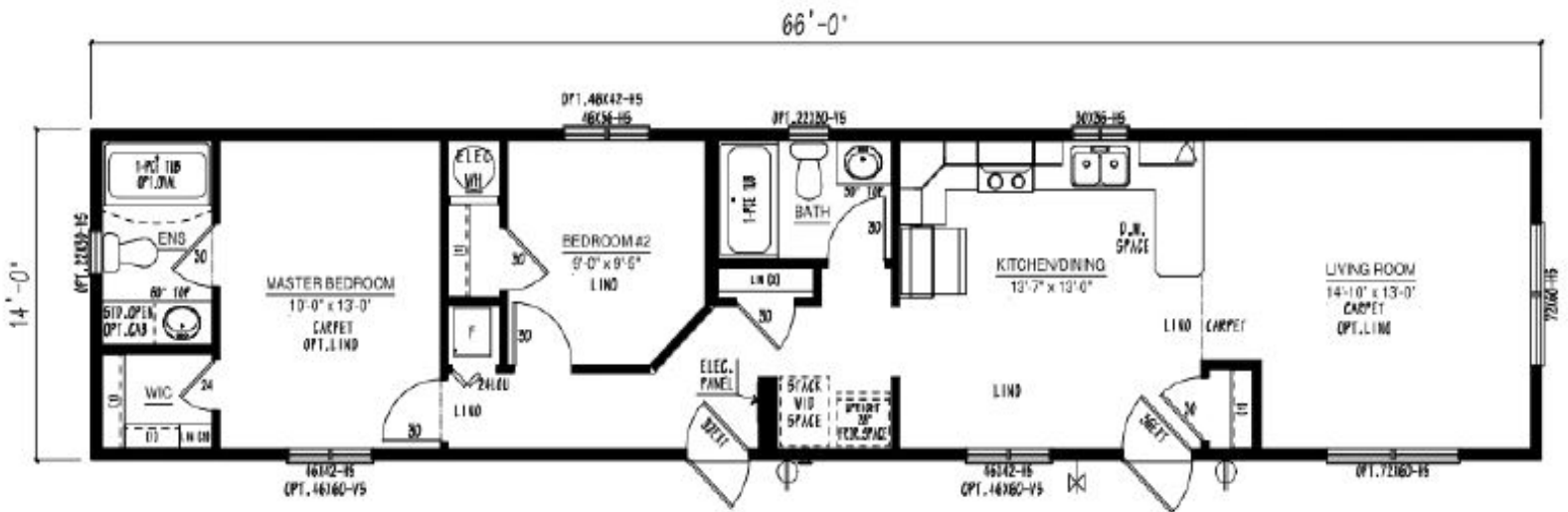

FRONT ELEVATION

Example of Exterior Elevation

- 924 Sqft
- 2 Bedroom
- 2 Bathroom



BC MERIDIAN SINGLE WIDE HOMES ~ 14' SERIES (14' BOX)

Built to the Residential CSA, Z-240 standards

CONSTRUCTION STANDARDS

Average ground snow load: 76 psf
4/12 roof pitch (1.75 interior pitch) @ 24" O/C
15/32" roof sheathing
Residential, maintenance-free vinyl siding
Lifetime Warranty* shingles w/full underlayment
Tubular steel frame with hitch
Floor joists: 2 x 8 @ 16" O/C
3/8" exterior wall sheathing (glued & fastened)
Colored metal fascia & soffit
Triple M rigid ext. wall system w/ insulated header
Frost free tap
Dedicated receptacle for heat tape at kitchen sink
23/32" floor sheathing (glued & fastened)
8' walls (2x6 exterior / 2x4 interior)
Exterior house wrap
12" front and rear eave overhang
1.5" side eaves w/ ridge venting
6 mil vapor barrier
Insulation:
Ceiling: R-40 Flat / R35 Cathedral
Floor: R-40
Walls: R-22
½" stippled Gyproc ceilings
Vaulted ceiling – living room, dining room,
kitchen & family room (plan specific)
Digital programable thermostat
Foam-back linoleum (fully glued & rolled)
Convertible gas furnace with electronic ignition
Coil cavity under furnace
40 US gallon electric HWT
Plumbed for washer, wired for dryer
100-amp electric service panel
1½" conduit from draw side of panel through floor
36" front and 32" rear exterior doors
White Mercer interior doors
Chrome round lever handle interior door hardware
32" utility room door
Flex coach light at all exterior doors
Exterior GFI receptacles at all exterior doors
Main water shut-off inside home at kitchen sink

DISTINCTIVE STANDARD FEATURES

Low E Argon windows & sills complete w/screens
1.5" side eave with ridge venting
12" front and rear overhang
½" painted drywall in Antique White
Nail holes in trim filled
Cordless cellular blinds throughout
Surface-mount interior pot lights in kitchen, dining room,
living room, family room (plan specific), walk-in pantries &
walk-in closets
Continuous rod shelving in closet

MODERN CRAFTED KITCHENS

Stainless steel 18cft fridge
Stainless steel ceran-top range w/SS range hood
Modular cabinets with adjustable shelving
Cabinet crown molding
Flat panel PVC cabinet doors throughout
Laminate countertops with self-edge
Single-row subway tile backsplash
Tight weave pantry shelving (where applicable)
Chrome gooseneck faucet with spray

CONTEMPORARY BATHS

De-humidistat on main bath fan, all other fans
on separate switch
1-Piece smooth back oval tub/shower combination in ensuite
(plan specific)
1-Piece smooth back tub/shower combination
in main bath
Chrome single-lever vanity faucets
Single-row subway tile backsplash at vanities